

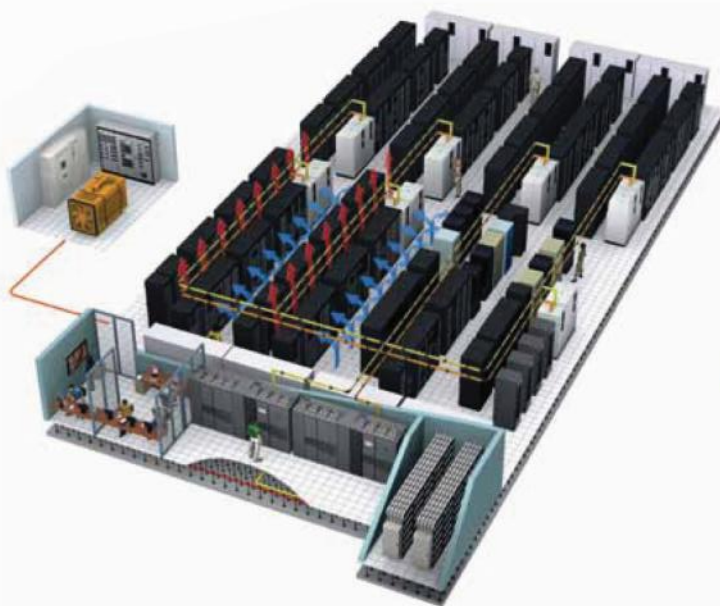

MGE Galaxy 9000

800 / 900 kVA

Dedicated system for large data centers and ultra sensitive, high power demand processes



MGE Galaxy 9000 Range		
UPS	800 kVA	900 kVA
Applications	Data Center	Process Industry
Power Factor	0.9	0.8
Short Circuit Capacities	1733 A	1949 A



Technical Specifications

Rated power (kVA)	800	900
Active Power (kW)	720	720
Normal AC supply input		
Input voltage range	323 V to 470 V	
Normal and backup supplies	Separate or Common	
Frequency	50 or 60 Hz +/- 10%	
THDI (with filter)	< 8 %	
Input power factor	> 0.85	
AC bypass input		
Input voltage range	340 V to 460 V	
Frequency	50 or 60 Hz +/- 10%	
Output		
Output voltage	380/400/415 v +/- 3%*	
Voltage regulation	+/- 1%	
Frequency	50 or 60 Hz	
Overload	150% 1 minute, 125% 10 minutes	
THDU	< 3%	
Batteries		
Backup time	5-10-15 minutes, others on request	
Type	Sealed / open lead acid, nickel cadmium	
Overall efficiency		
Double conversion	Up to 95%	
Environmental conditions		
Storage temperature	-20°C to +45°C dry	
Operating temperature	up to 35°C (1)	
Noise	< 75 dBA	
Operating altitude (without derating)	< 1000 m	
Parallel operation		
Integrated parallel	up to 4	
With Static Switch Cubicle	up to 6	
Standards		
Construction and safety	IEC 62040-1, IEC 60950, EN50091-1	
Performance and topology	IEC 62040-3, EN50091-3	
Design and manufacture	ISO 14001, ISO 9001, IEC 60146	
EMC immunity	IEC 61000-4	
EMC emissions	IEC 62040-2, EN 50091-2 Class 3	
Dimensions and weight (height 2000 mm; depth : 840 mm)		
UPS		
Width (mm)	3,600	
Weight (kg)	4,100	
UPS + 12 Pulse		
Width (mm)	4,400	
Weight (kg)	5,600	

*Customizable to address long cable distances when needed.