

Specifications

| | | |
|---|--------------|---|
| Nominal Voltage | | 12 V |
| Capacity (25°C) | 20HR(10.5V) | 26 Ah |
| | 10HR(10.5V) | 24.2Ah |
| | 1HR(9.60V) | 16.3Ah |
| Dimension | Length | 165 ± 2mm (6.50inch) |
| | Width | 176 ± 2mm (6.93inch) |
| | Height | 127 ± 2mm (5.00inch) |
| | Total Height | 127 ± 2mm (5.00inch) |
| Approx. Weight | | 7.9kg (17.4lbs) ± 4% |
| Terminal type | | T3/T8 |
| Internal resistance (Fully charged, 25°C) | | Approx. 12m Ω |
| Capacity affected by temperature (20HR) | 40°C | 102% |
| | 25°C | 100% |
| | 0°C | 85% |
| | -15°C | 65% |
| Self-discharge (25°C) | 3 month | Remaining Capacity: 91% |
| | 6 month | Remaining Capacity: 82% |
| | 12 month | Remaining Capacity: 65% |
| Nominal operating temperature | | 25°C ± 3°C (77°F ± 5°F) |
| Operating temperature range | Discharge | -15°C ~ 50°C (5°F ~ 122°F) |
| | Charge | -10°C ~ 50°C (14°F ~ 122°F) |
| | Storage | -20°C ~ 50°C (-4°F ~ 122°F) |
| Float charging voltage(25°C) | | 13.60 to 13.80V Temperature compensation: -18mV/°C |
| Cyclic charging voltage(25°C) | | 14.50 to 14.90V Temperature compensation: -30mV/°C |
| Maximum charging current | | 7.8A |
| Terminal material | | Copper |
| Maximum discharge current | | 390A(5 sec.) |
| Designed floating life(20°C) | | 8~10years |

- ◆ Absorbent glass mat technology;
- ◆ Recognized by UL & CE;
- ◆ ABS container.

Constant Current Discharge Characteristics (A, 25°C)

| F.V/TIME | 10min | 15min | 30min | 60min | 2h | 3h | 4h | 5h | 8h | 10h | 20h |
|----------|-------|-------|-------|-------|------|------|------|------|------|------|------|
| 9.60V | 60.0 | 47.5 | 26.5 | 16.3 | 9.24 | 6.63 | 5.30 | 4.51 | 2.92 | 2.45 | 1.32 |
| 9.90V | 58.2 | 46.4 | 26.0 | 16.0 | 9.18 | 6.59 | 5.27 | 4.48 | 2.90 | 2.44 | 1.31 |
| 10.2V | 55.8 | 44.7 | 25.2 | 15.6 | 9.10 | 6.55 | 5.24 | 4.45 | 2.88 | 2.43 | 1.31 |
| 10.5V | 53.4 | 43.1 | 24.6 | 15.3 | 8.96 | 6.50 | 5.20 | 4.42 | 2.86 | 2.42 | 1.30 |
| 10.8V | 50.4 | 40.9 | 23.7 | 14.8 | 8.74 | 6.31 | 5.04 | 4.29 | 2.77 | 2.37 | 1.27 |

Constant Power Discharge Characteristics (Watt, 25°C)

| F.V/TIME | 10min | 15min | 30min | 60min | 2h | 3h | 4h | 5h | 8h | 10h | 20h |
|----------|-------|-------|-------|-------|-----|------|------|------|------|------|------|
| 9.60V | 677 | 542 | 304 | 188 | 108 | 78.8 | 63.2 | 53.8 | 35.0 | 29.5 | 15.8 |
| 9.90V | 656 | 529 | 298 | 185 | 107 | 78.3 | 62.8 | 53.5 | 34.8 | 29.3 | 15.8 |
| 10.2V | 629 | 509 | 289 | 181 | 106 | 77.8 | 62.4 | 53.1 | 34.6 | 29.2 | 15.7 |
| 10.5V | 602 | 492 | 282 | 177 | 105 | 77.2 | 61.9 | 52.8 | 34.3 | 29.0 | 15.6 |
| 10.8V | 569 | 466 | 271 | 172 | 102 | 74.9 | 60.1 | 51.2 | 33.3 | 28.4 | 15.3 |

Note: The above characteristics data can be obtained within three charge/discharge cycles.

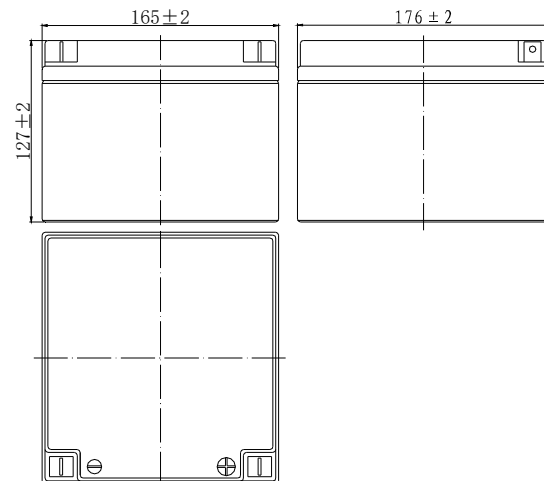
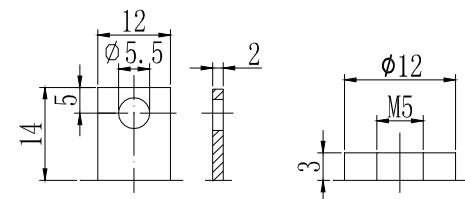
Dimensions

Terminal

Terminal T3

Terminal T8

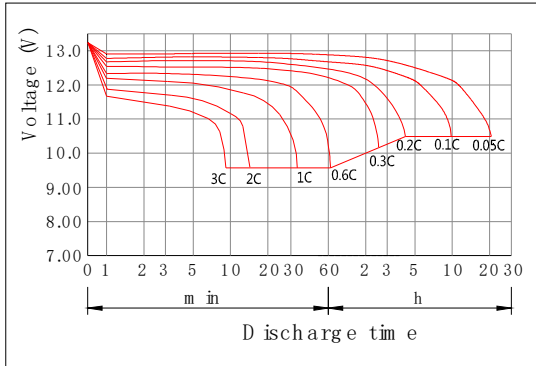
Discharge Characteristics(25°C)



Charging Characteristics(25°C)

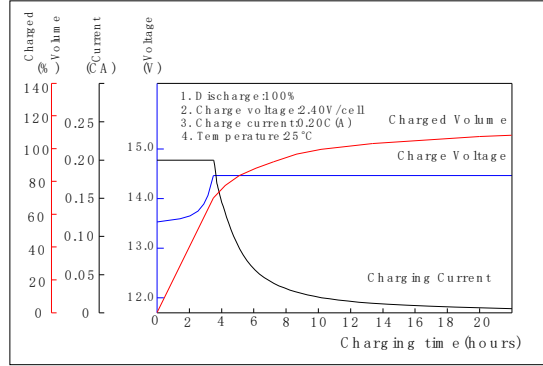

Effect of Temperature on Capacity

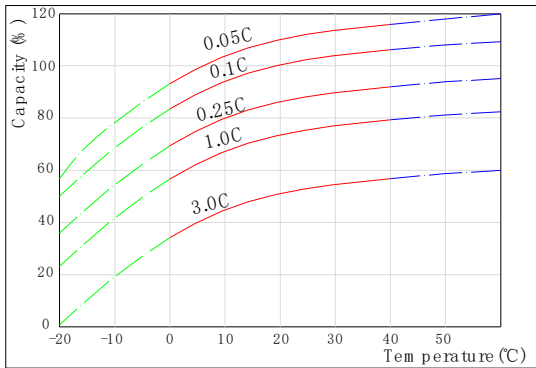

Self-discharge Characteristics

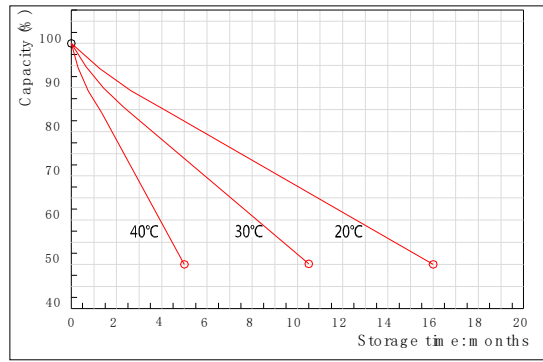

The Relationship for Open Circuit Voltage and Residual Capacity (25°C)

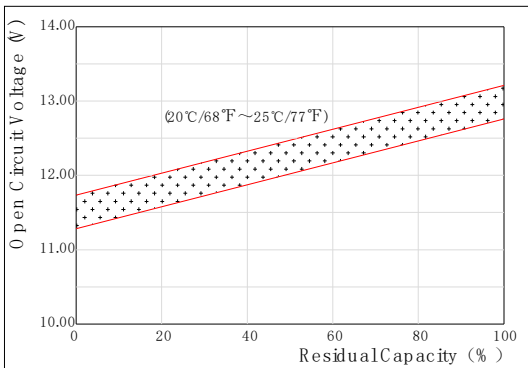

The Relationship for Charging Voltage and Temperature

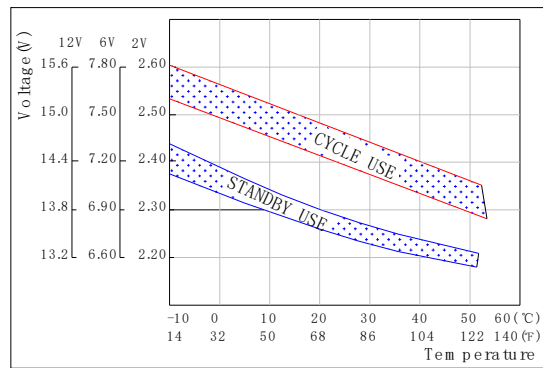

Floating Life on Temperature

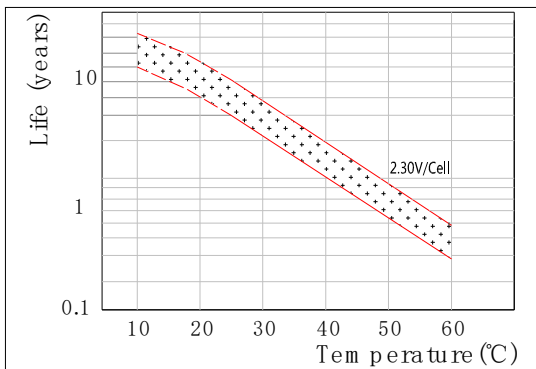

Cycle Life on D.O.D(25°C)

